

Lock Plug

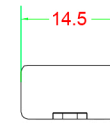
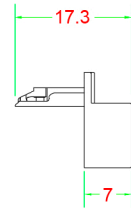
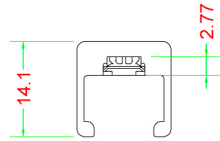
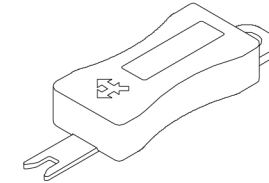
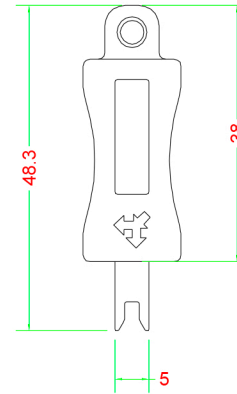
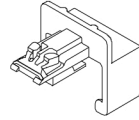
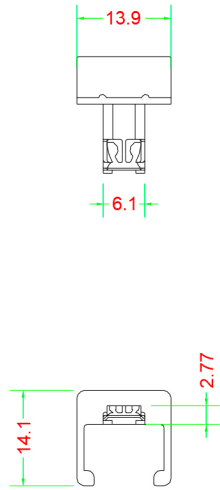

Materials:

Body : Fireproof Nylon-66

Operation Temperature : -20 °C ~ +70 °C

Materials:

Plastic : Fireproof ABS UL-94V0

Metal : SPCC

Operation Temperature : -20 °C ~ +70 °C

DRAW NO:		ITEM NO:	
	APPR	CUSTOMER:	
UNIT: m/m	DESIGN	DATE:	
SCALE:	Ref. NO:	TOLERANCE:	· ± 1 · X ± 0.2 · XX ± 0.15