



LOCK-PLUG



LOCK-INSERT



PLUG-SOS

# LOCK PLUG INSTRUCTION MANUAL

PATENTED

## A : How to install Lock-Plug

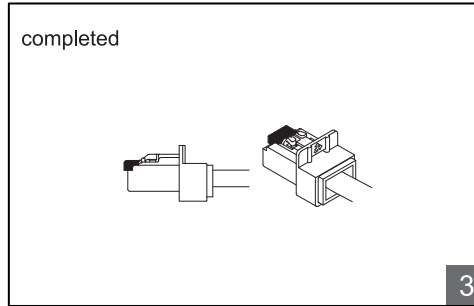
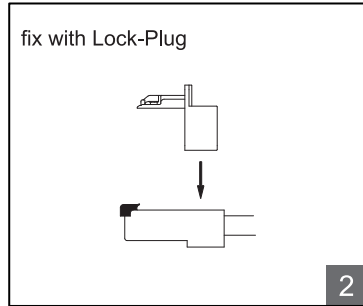
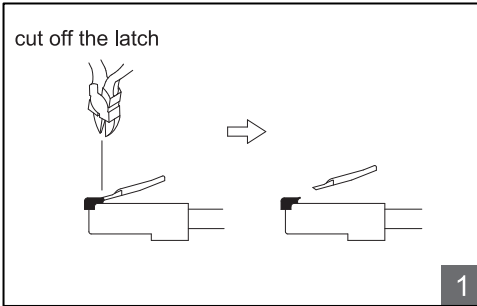

## B : How to secure Lock-Plug into port

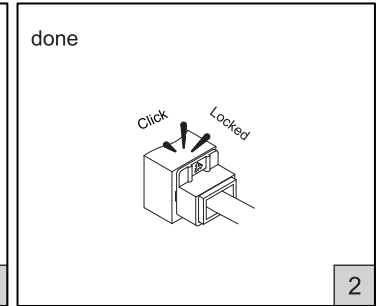
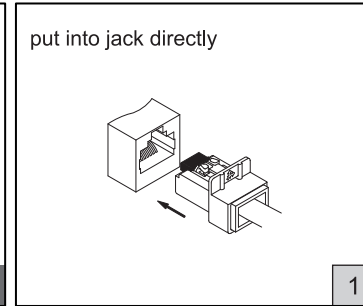

## C : How to release Lock-Plug

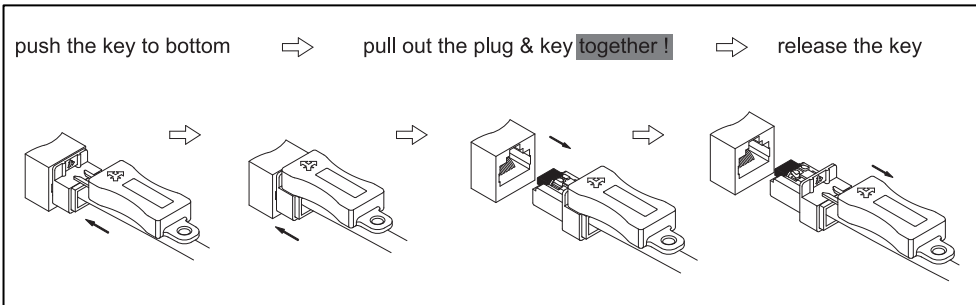

## D : How to exchange Lock-Plug & Plug-SOS

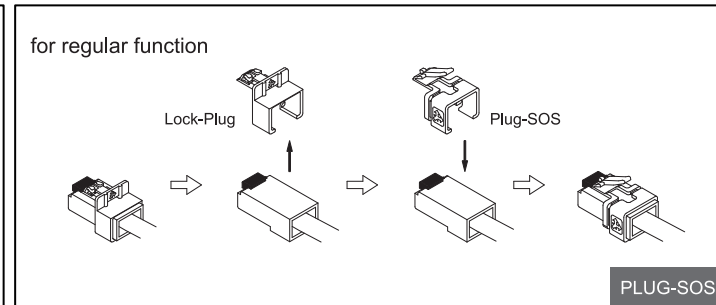

## E : How to secure Lock-Insert

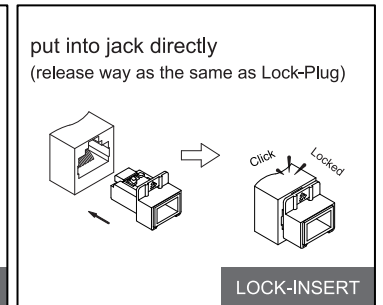

## ⚠ WARNING

use finger to bend the latch to make a creasing line, then align the cutter with the creasing line to cut off the latch

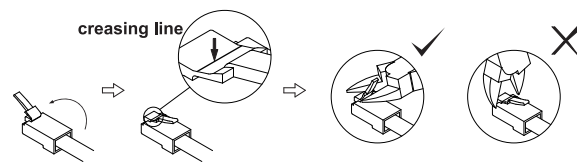

always check for proper fixing of the latch or it can cause jam in the jack !

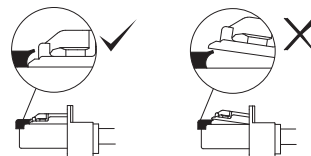

always to remove the key from Lock-Plug to avoid clip part elastic fatigue

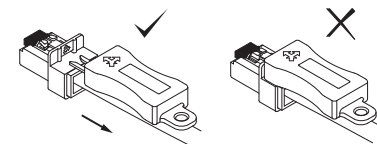

if clip part elastic fatigue, bend the clip outward

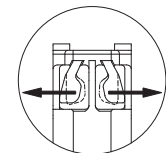

trim away any part of boot or Lock-Plug to get the best matching

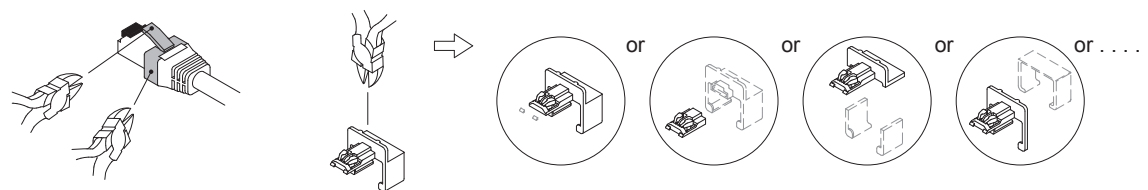

if high density jack does not clip, use thumb to push black area to lock

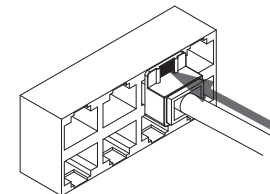

may not be suitable for some top opened, too high, or special jacks

